

SUMMIT	Length (ft)	Width (ft)	Height (ft)	Max Height (ft)	Area (sq ft)	U-Shape	Theatre	Classroom	Hollow Square	Reception	Banquet
TALUS	75	39	10	14	2806	60 guests	200 guests	150 guests	68 guests	200 guests	150 guests
SUMMIT BOARD ROOM	22	18	8	94	19	16 guests	36 guests	--	--	--	--

* Please note, the guest capacity figures above do not account for space needed to accommodate F&B configurations

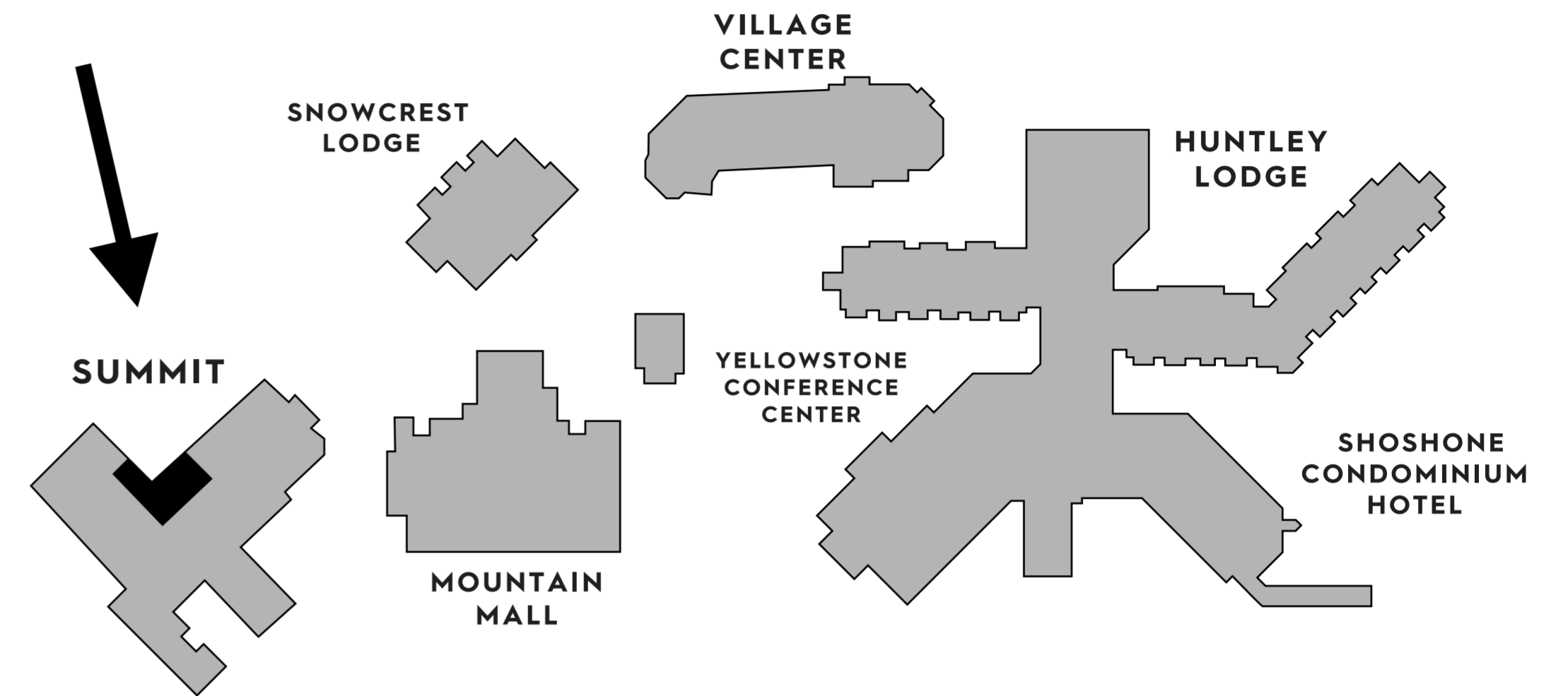

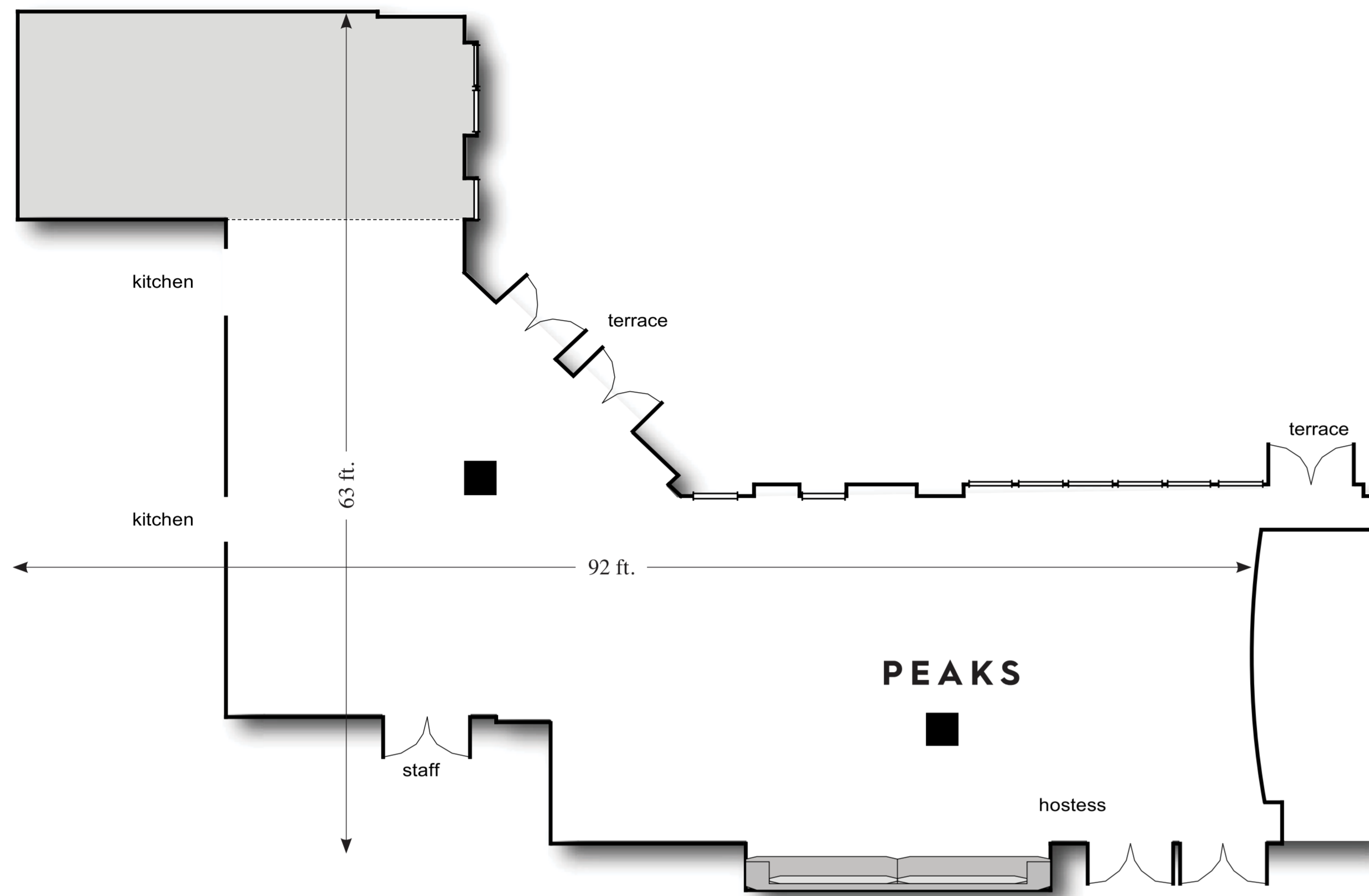

SUMMIT HOTEL	Length (ft)	Width (ft)	Height (ft)	Max Height (ft)	Area (sq ft)	Reception	Banquet
PEAKS	63	92	8	9	2597	200 guests	120 guests
PEAKS OUTDOOR TERRACE	--	--	--	--	2925	200 guests	66 guests

* Please note, the guest capacity figures above do not account for space needed to accommodate F&B configurations



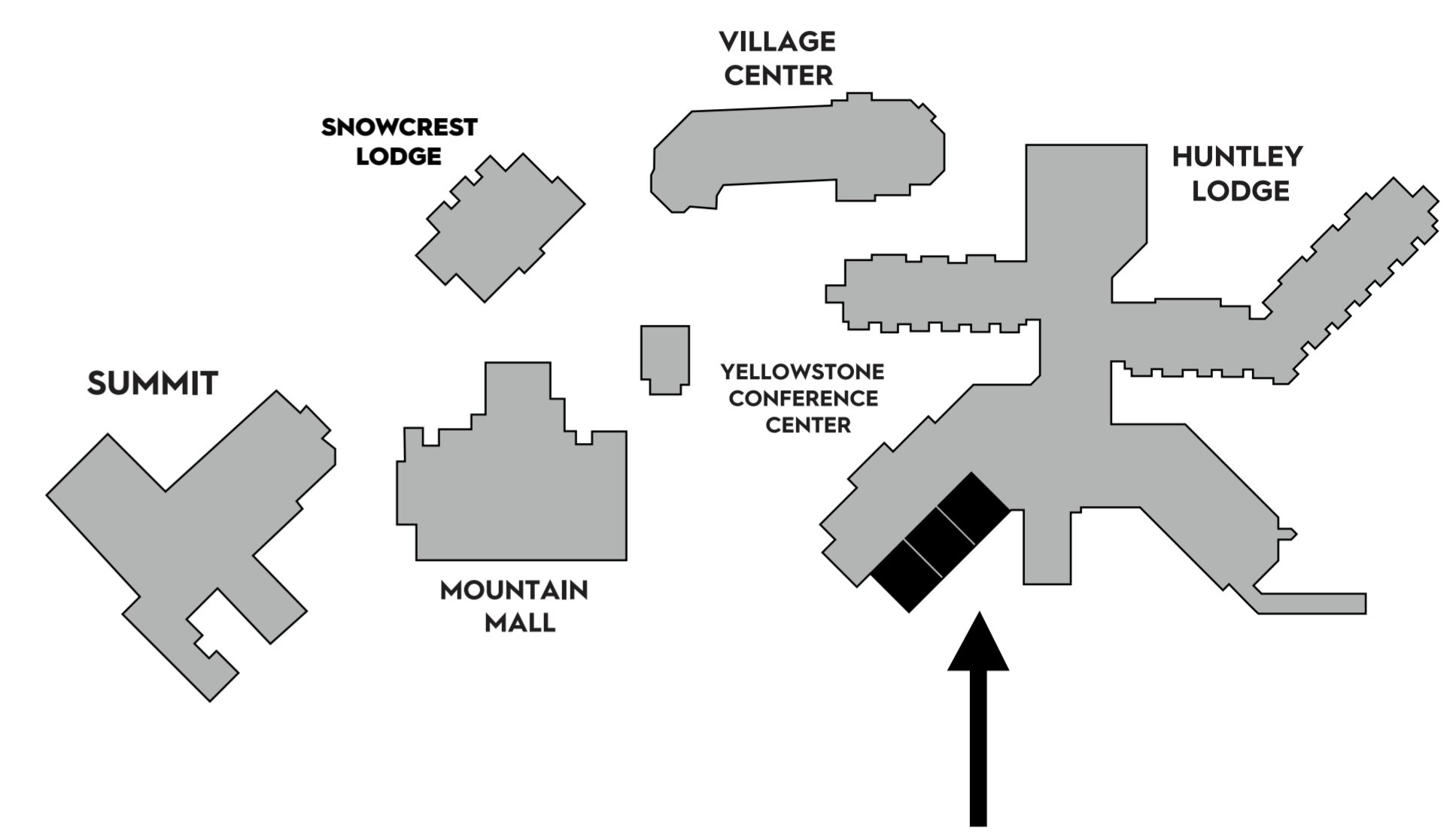
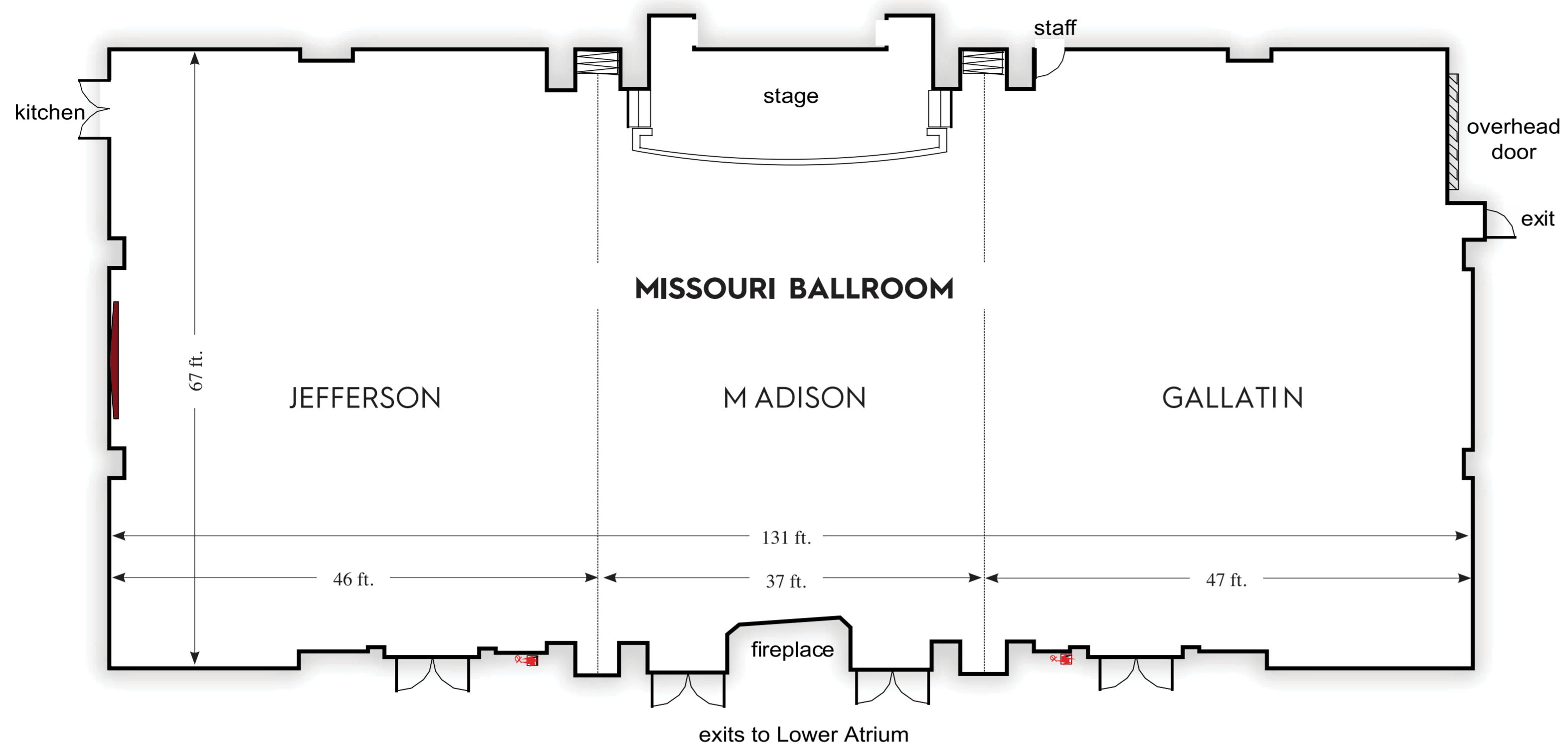

	Square Footage	Theater	Classroom	Banquet	U-Shape/ Conference	Hollow Square	Reception	Ceiling Height
MISSOURI BALLROOM	7,991	750	500	550	--	--	1,000	34'
Jefferson	2,961	250	150	150	56	72	370	20'
Madison	2,069	150	100	100	40	56	260	34'
Gallatin	2,961	250	150	150	56	72	370	20'

* Please note, the guest capacity figures above do not account for space needed to accommodate F&B configurations





MISSOURI BALLROOM • YELLOWSTONE CONFERENCE CENTER

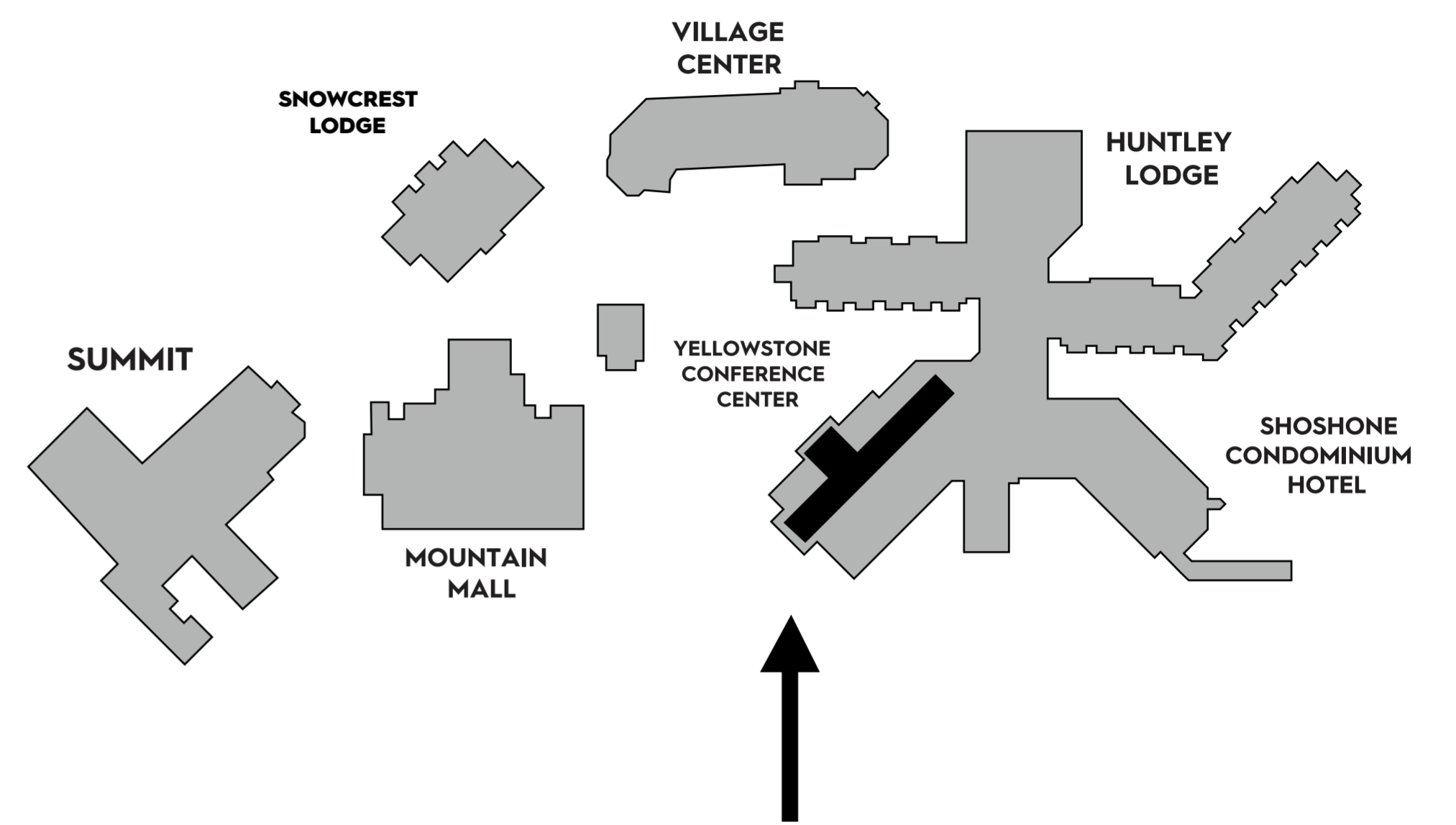
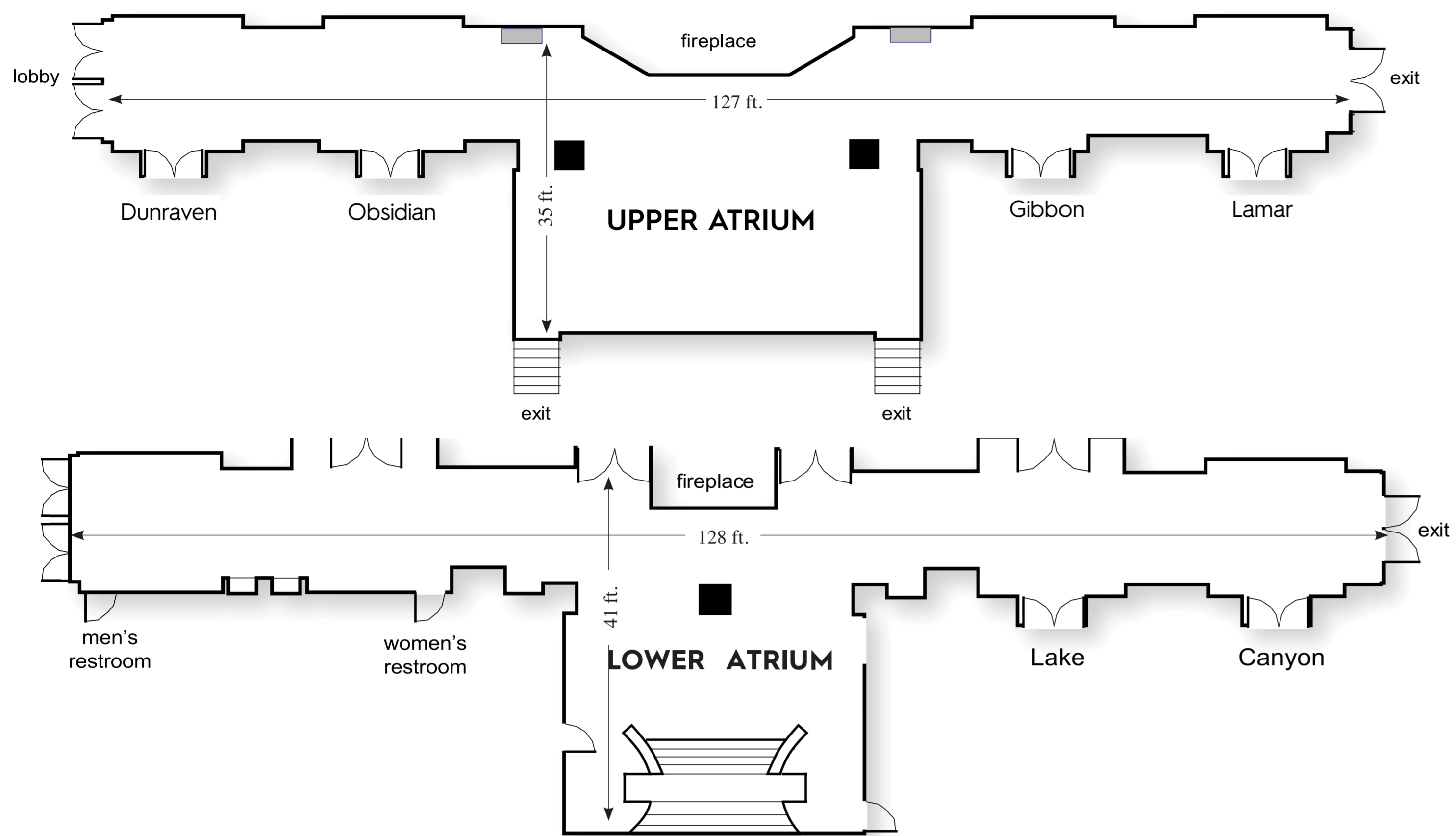

YELLOWSTONE CONFERENCE CENTER							
	Length (ft)	Width (ft)	Height (ft)	Max Height (ft)	Area (sq ft)	Reception	Banquet
UPPER ATRIUM	127	35	82	2	2494	150 guests	49 guests
LOWER ATRIUM	128	41	82	92	349	150 guests	49 guests

* Please note, the guest capacity figures above do not account for space needed to accommodate F&B configurations



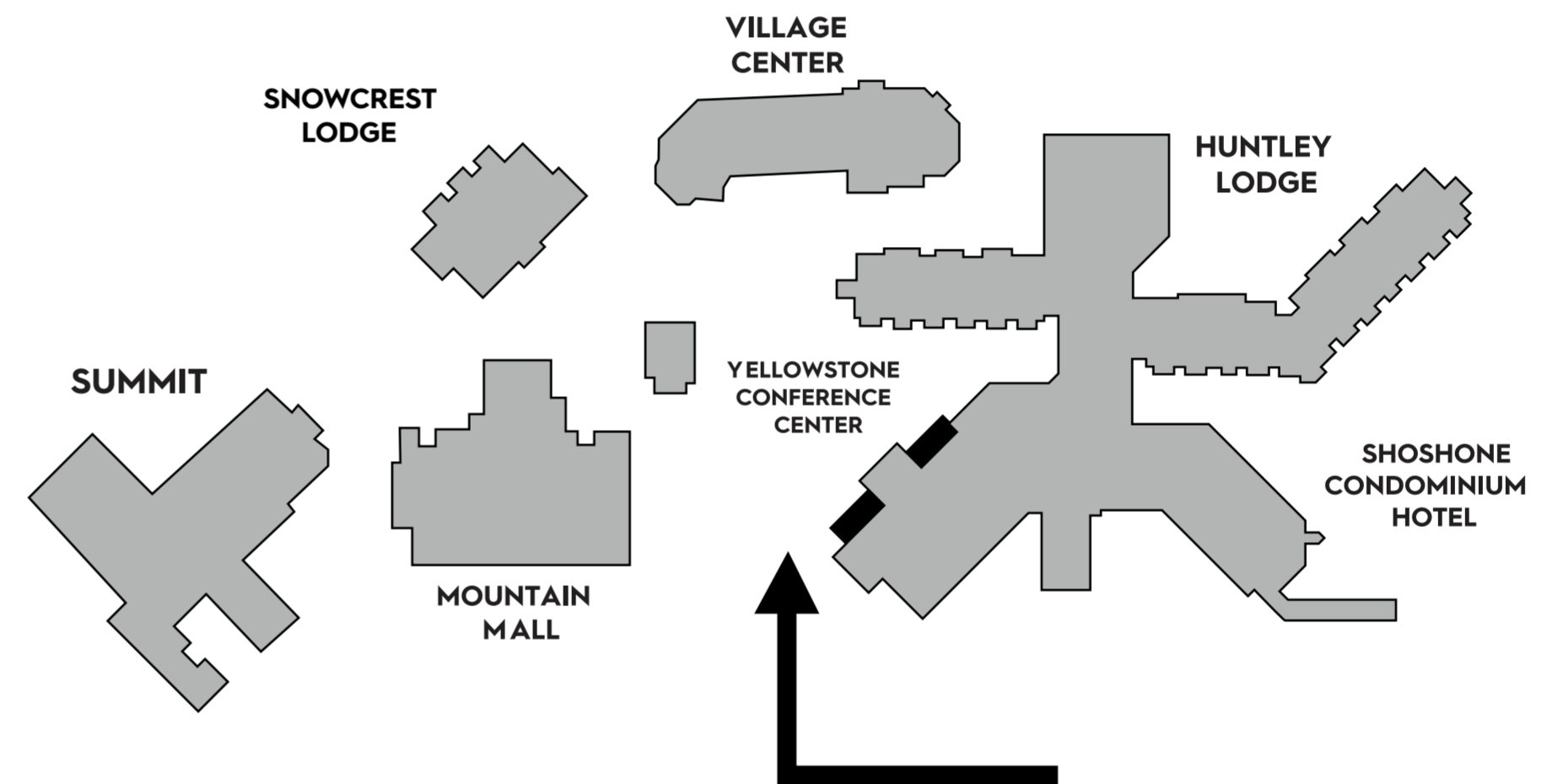
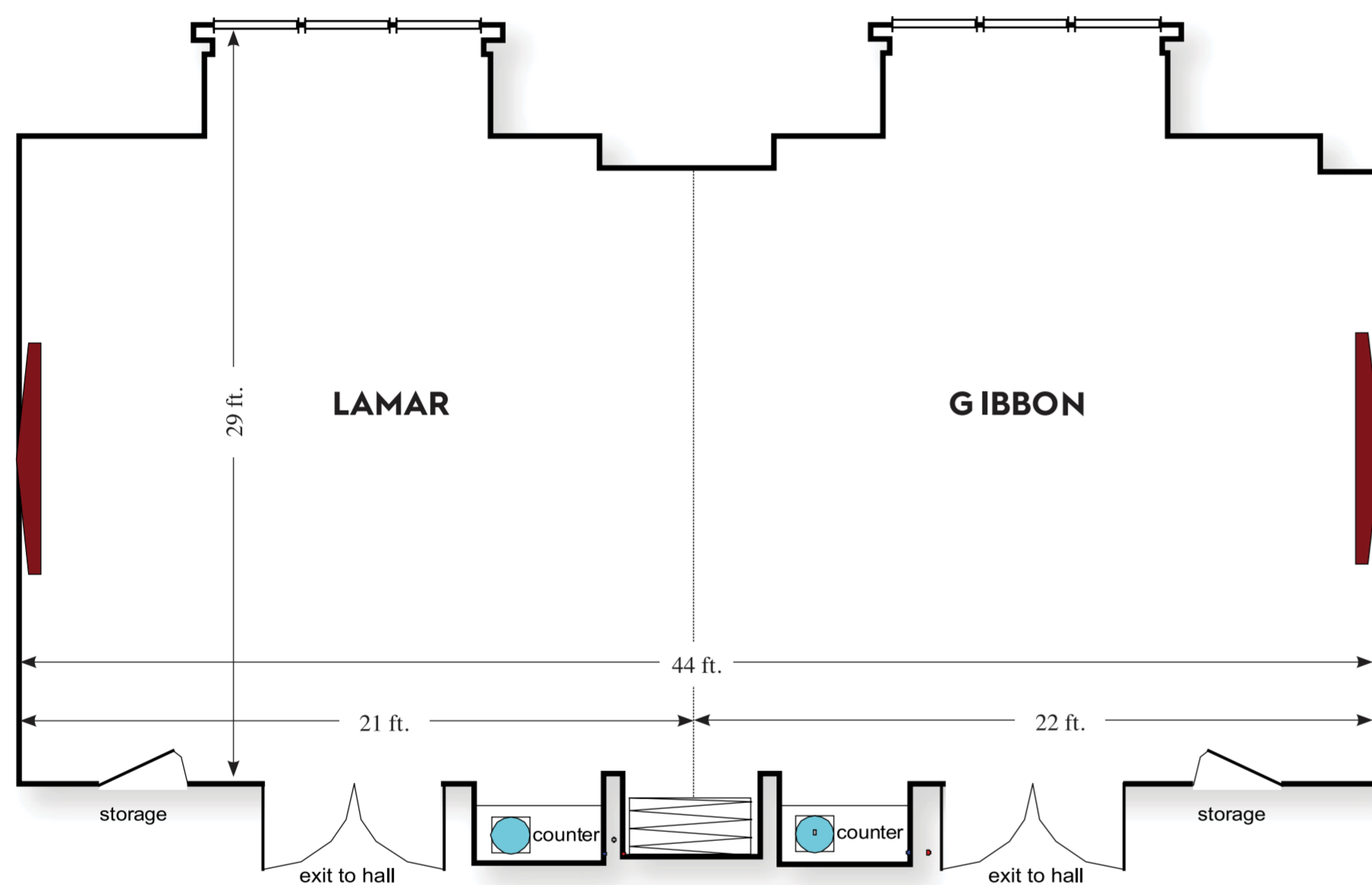
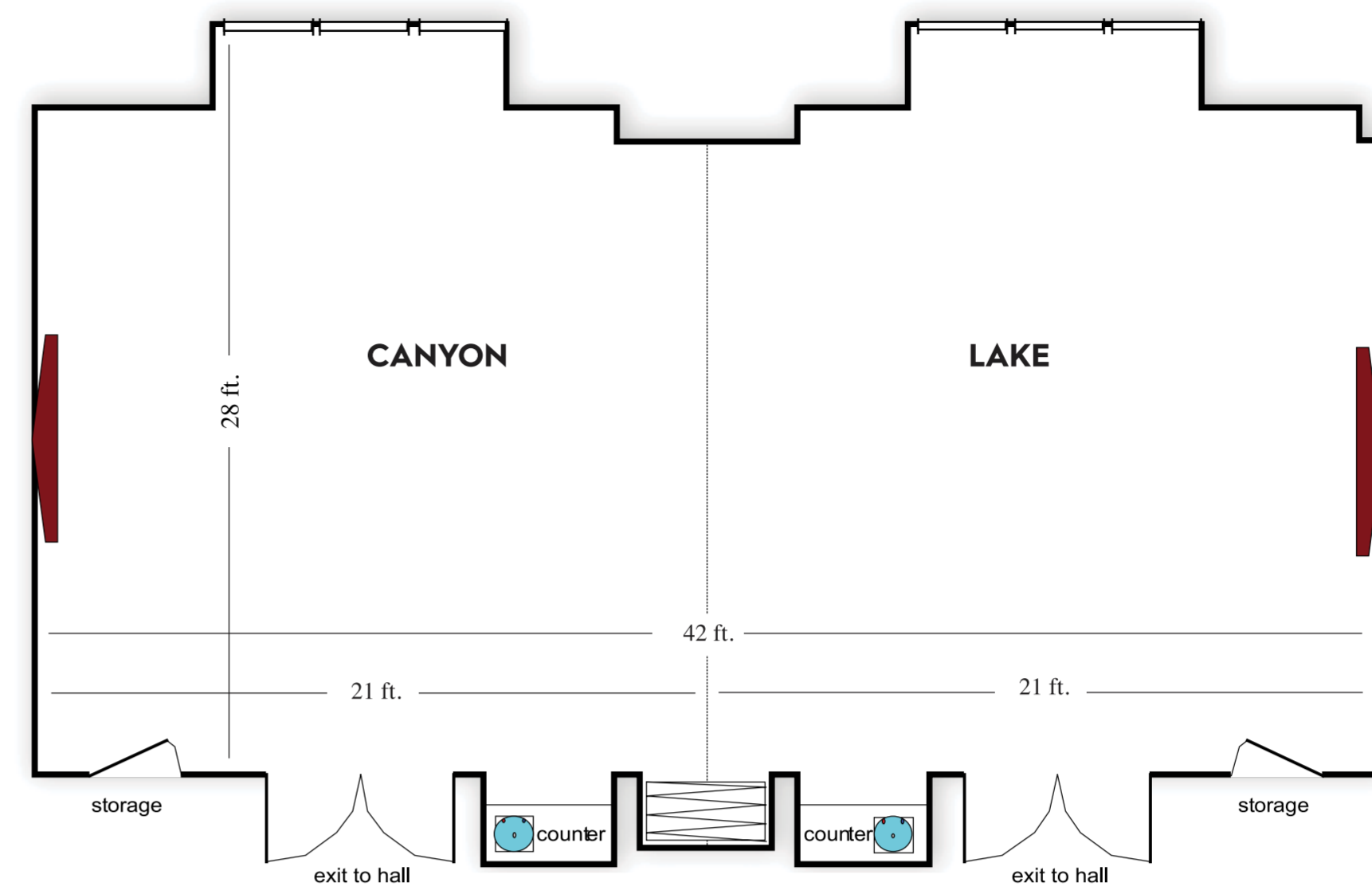
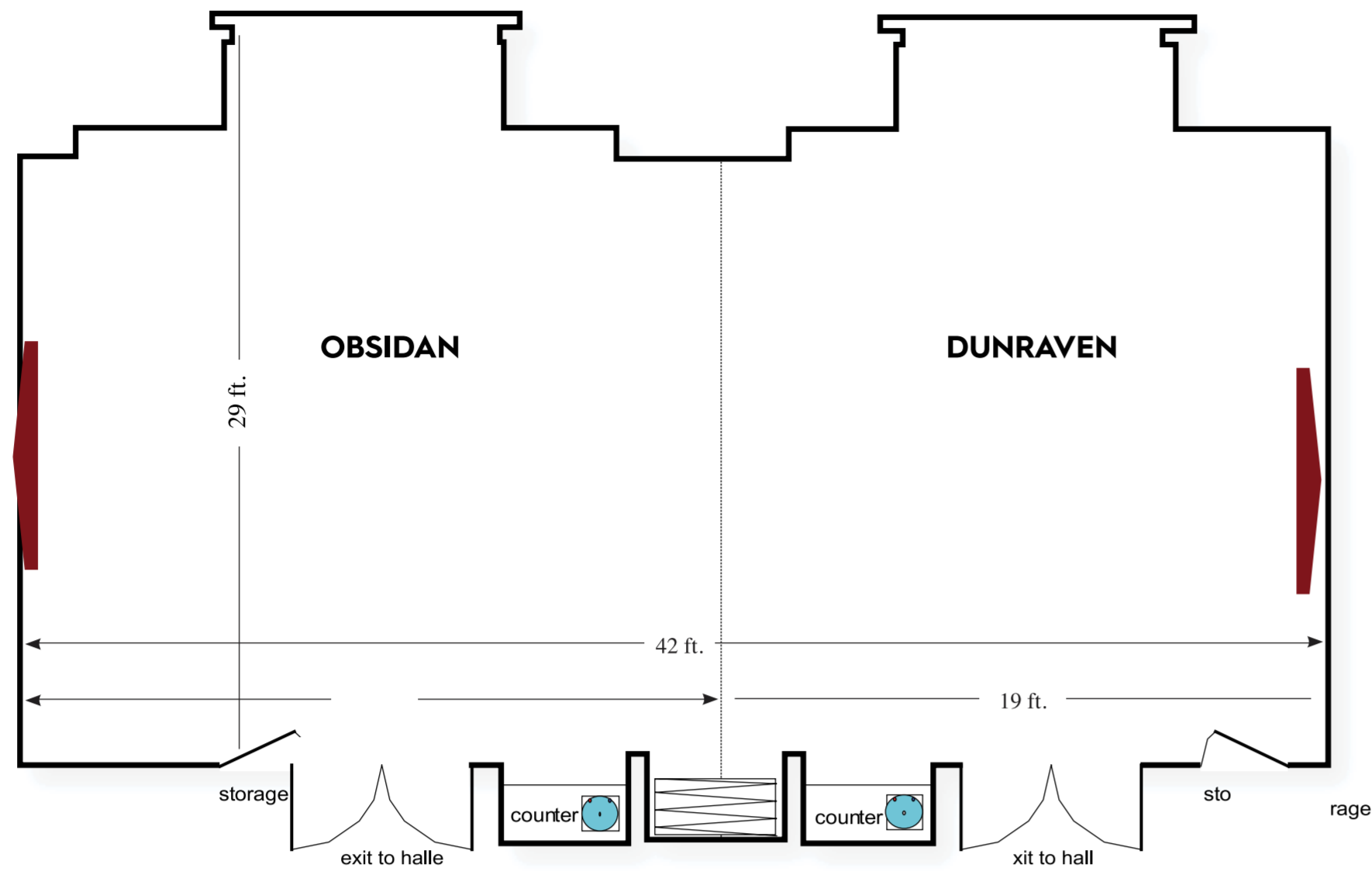

	Square Footage	Theater	Classroom	Banquet	U-Shape/ Conference	Hollow Square	Reception	Ceiling Height
DUNRAVEN/OBSIDIAN	946	80	48	54	32	40	1001	0'6"
LAKE/CANYON	924	80	48	54	32	40	100	9'2"
LAMAR/GIBBON	968	80	48	54	32	40	100	10'6"

* Please note, the guest capacity figures above do not account for space needed to accommodate F&B configurations



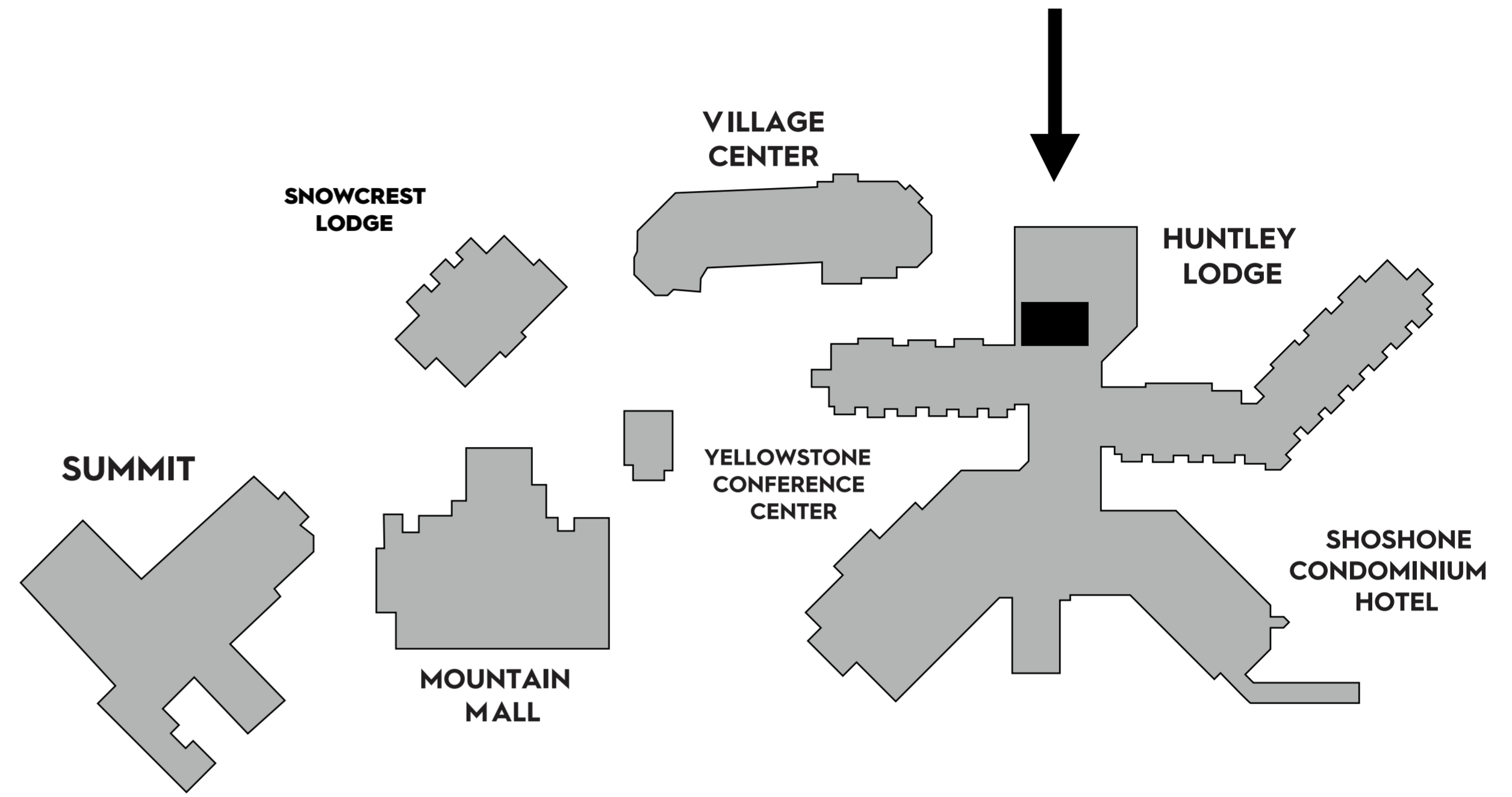
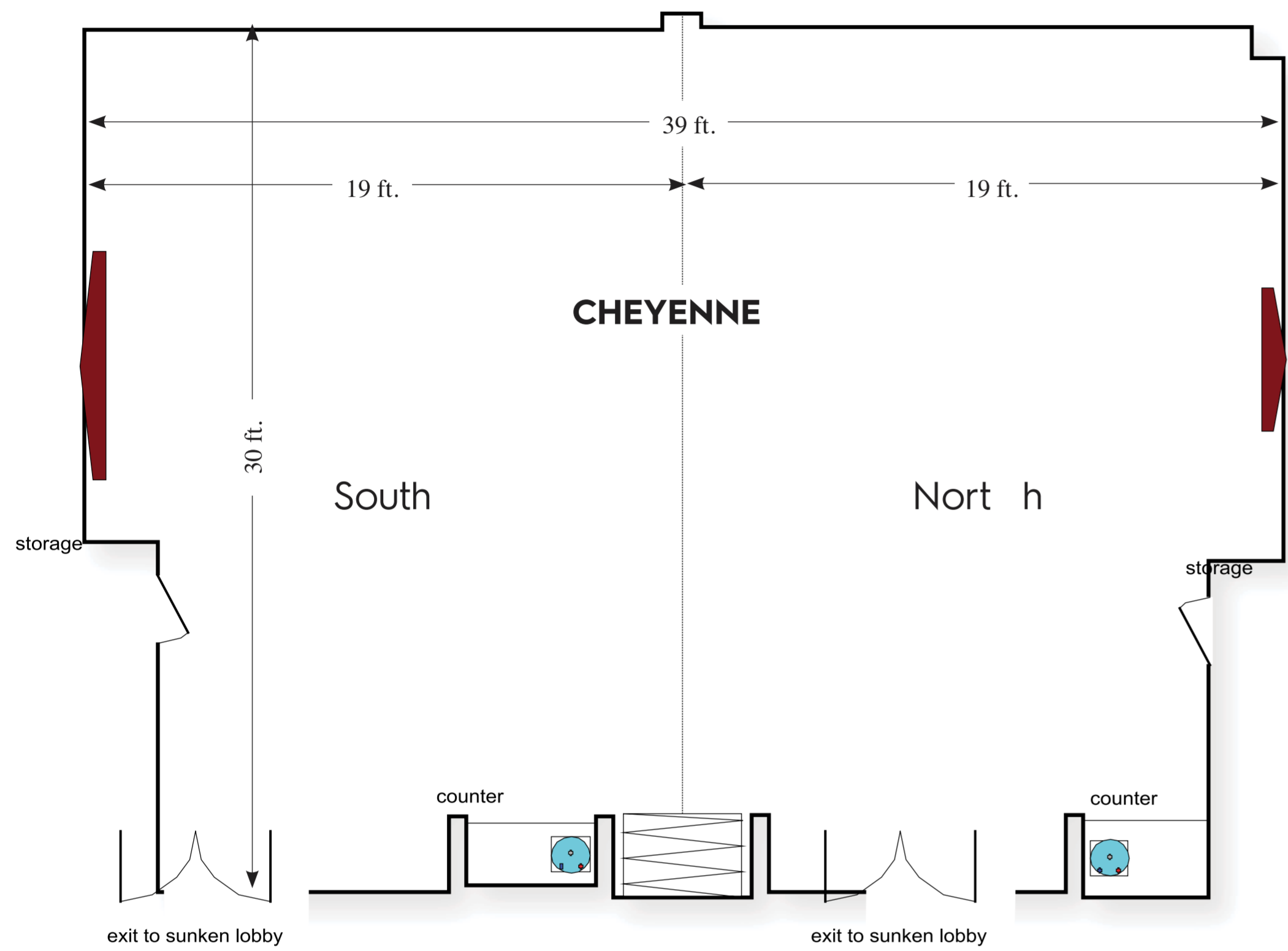

HUNTLEY LODGE	Square Footage	Theater	Classroom	Banquet	U-Shape/ Conference	Hollow Square	Reception	Ceiling Height
Cheyenne Room	1,120	480	85	43	24	0	100	8'

* Please note, the guest capacity figures above do not account for space needed to accommodate F&B configurations

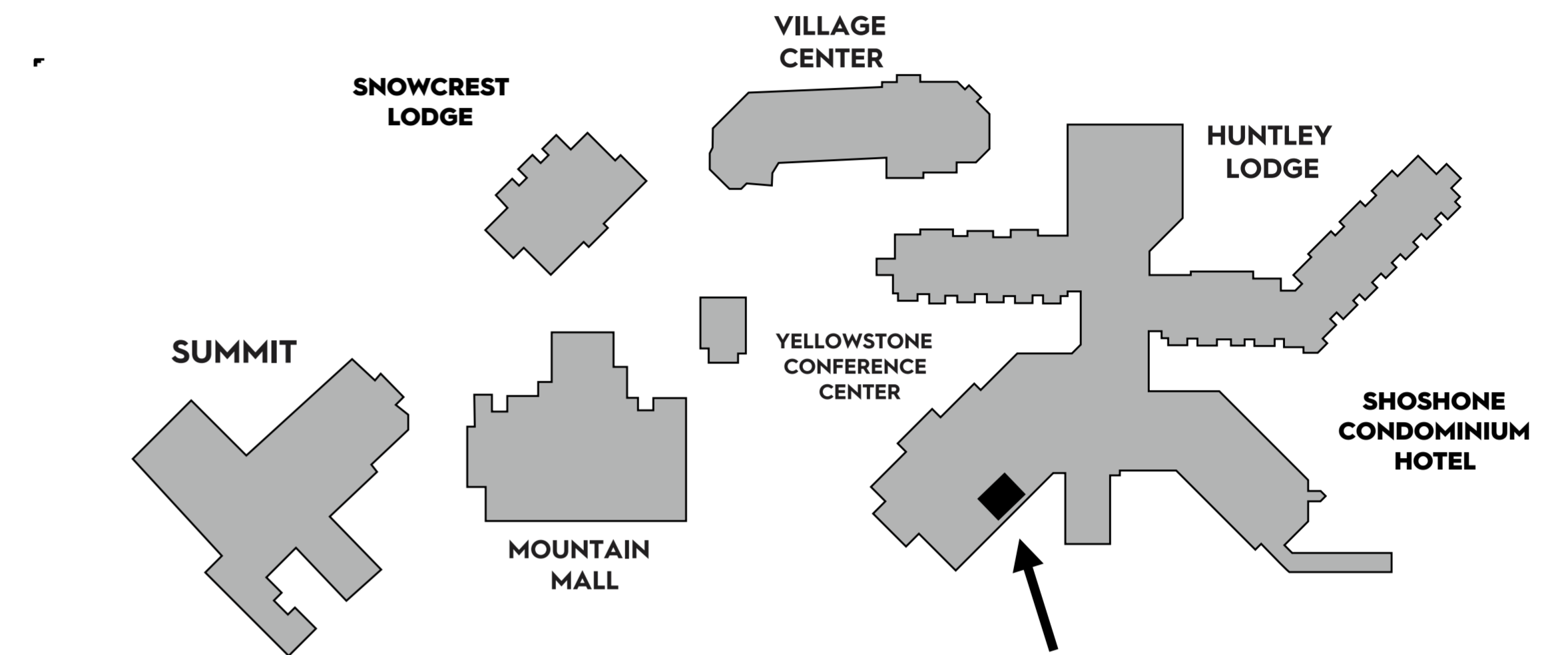

	Square Footage	Theater	Classroom	Ceiling Height
AMPHITHEATER	1,200	131	131	varies

* Please note, the guest capacity figures above do not account for space needed to accommodate F&B configurations

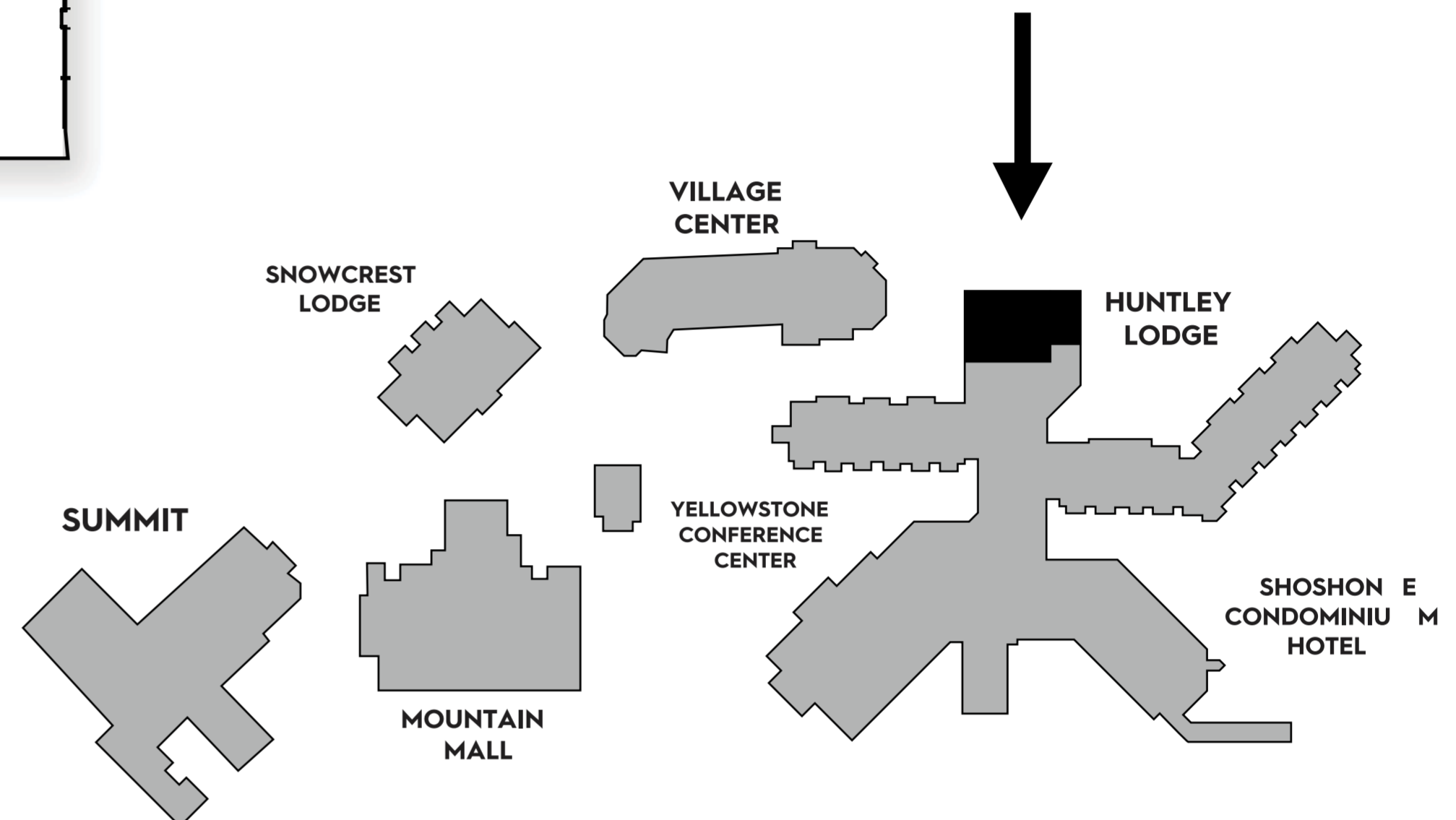
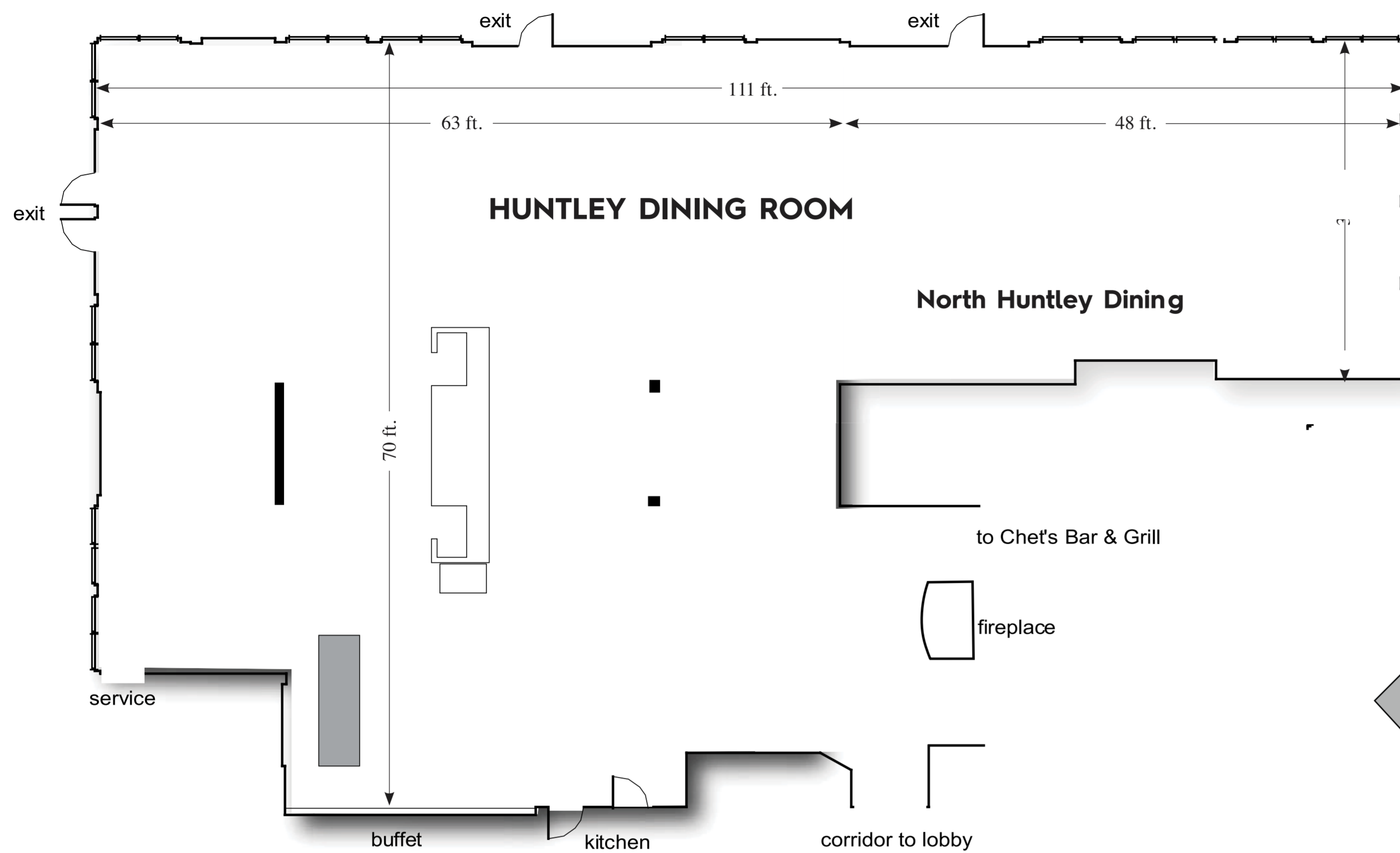

HUNTLEY LODGE	Length (ft)	Width (ft)	Height (ft)	Max Height (ft)	Area (sq ft)	Reception	Banquet
HUNTLEY DINING ROOM	70	111	18	20	5659	400 guests	295 guests
NORTH HUNTLEY DINING	38	48	18	20	1440	125 guests	75 guests

* Please note, the guest capacity figures above do not account for space needed to accommodate F&B configurations